



INFORMATION PACK FOR ALL BANDS COMPETING IN THE SECOND SECTION 2017

WELCOME to Wychavon 2017!

All of this info has been prepared in response to requests from bands in the past . **Please share this info with your band members!**

Here you will find information about road access to the venues and information about the halls in which you will play. Please note all the details given here are subject to change.

The pack includes:

- Access maps to get you in and out of Evesham, including the post code for Sat Nav users.
- General plans of the venues at De Montfort and their relative positions.
- DIAGRAMS AND IMAGES OF EACH OF THE PLAYING HALLS FOR YOUR SECTION
- **PERCUSSION PROVISION AND LAYOUT**
- Info about catering arrangements

PARKING ARRANGEMENTS:

When you arrive at De Montfort school gates you will be directed to various parking areas by stewards. Please listen to what they say!

Coach parking is still being arranged. We need to know how many coaches will turn up so please let Kevin know asap so we can organise this. There is a small area set aside at the school for coach parking. The maps show other possible coach parking areas.

Car parking: At De Montfort main site there are a small number of places only for band and public car parking. Priority goes to committee, adjudicators and traders.

However, there is ample parking (80 places) at the (now closed) De Montfort Lower School. Which is about 150 metres away. A shuttle bus will run between the sites for most of the day.



GETTING THERE!
 De Montfort School
 Four Pools Road,
 Evesham,
 Worcestershire
 WR11 1DQ

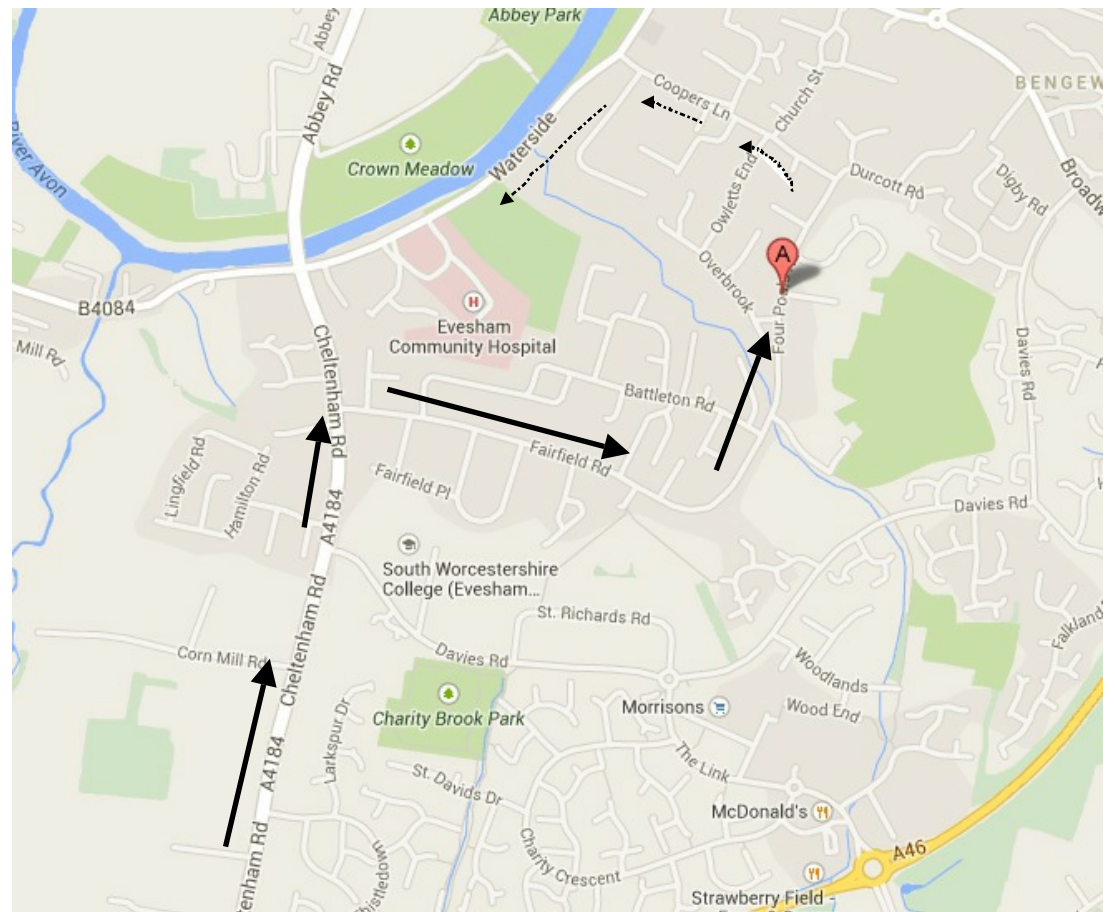
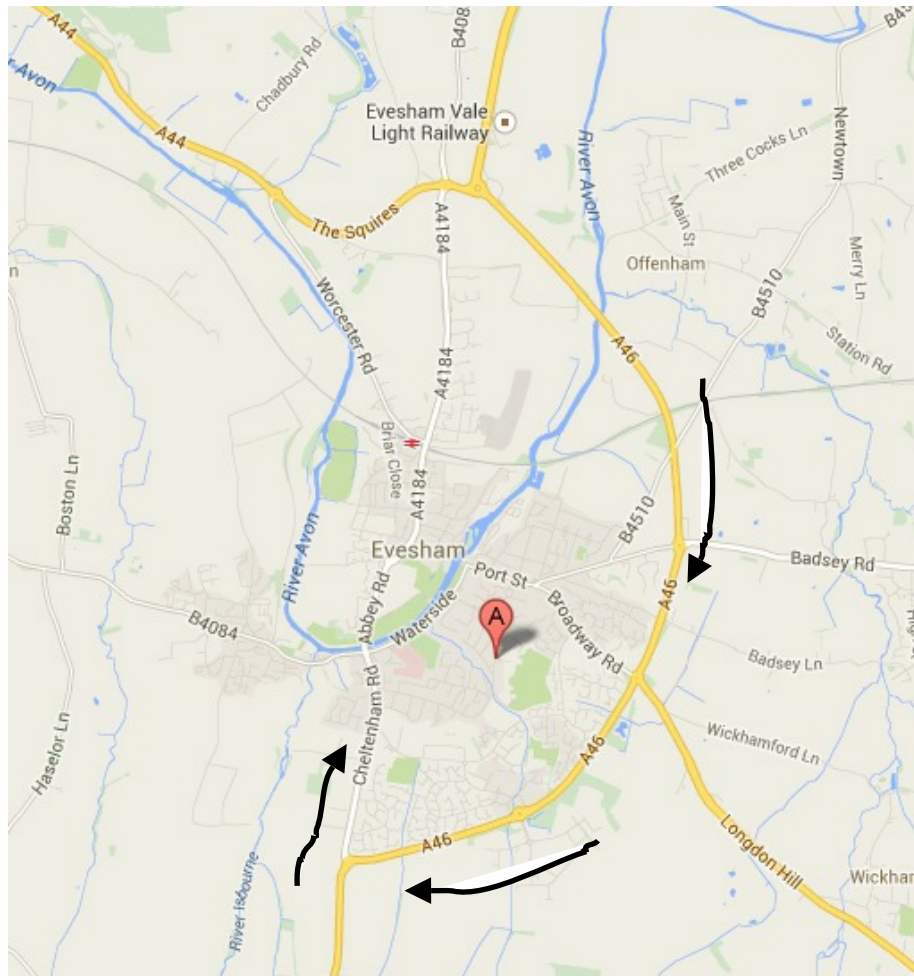

Access to De Montfort High School:

From the North: go along A46 following the by-pass (yellow on the map) round the town to the southern most point. Once meeting the roundabout at the Cheltenham road go right along the A4184 towards the town centre. Turn right onto Fairfield Road. This leads into Four Pools Road. Both schools are on the right (A on map).

De Montfort School is on Four Pools Lane, just off four Pools Road.

From the South: Follow the direction given above from the Cheltenham Road roundabout.

After dropping off, coaches should carry on along Four Pools Road into Coopers Lane and then left along Waterside. This route avoids going through the town centre. FULL INFO ABOUT COACH PARKING ETC TO FOLLOW.



De Montfort School
Four Pools Road,
Evesham,
Worcestershire
WR11 1DQ

ALL Sections competing here in 2016.

The De Montfort Middle School
Four Pools Lane,
Evesham,
WR11 1DL

No competition but parking available this year!

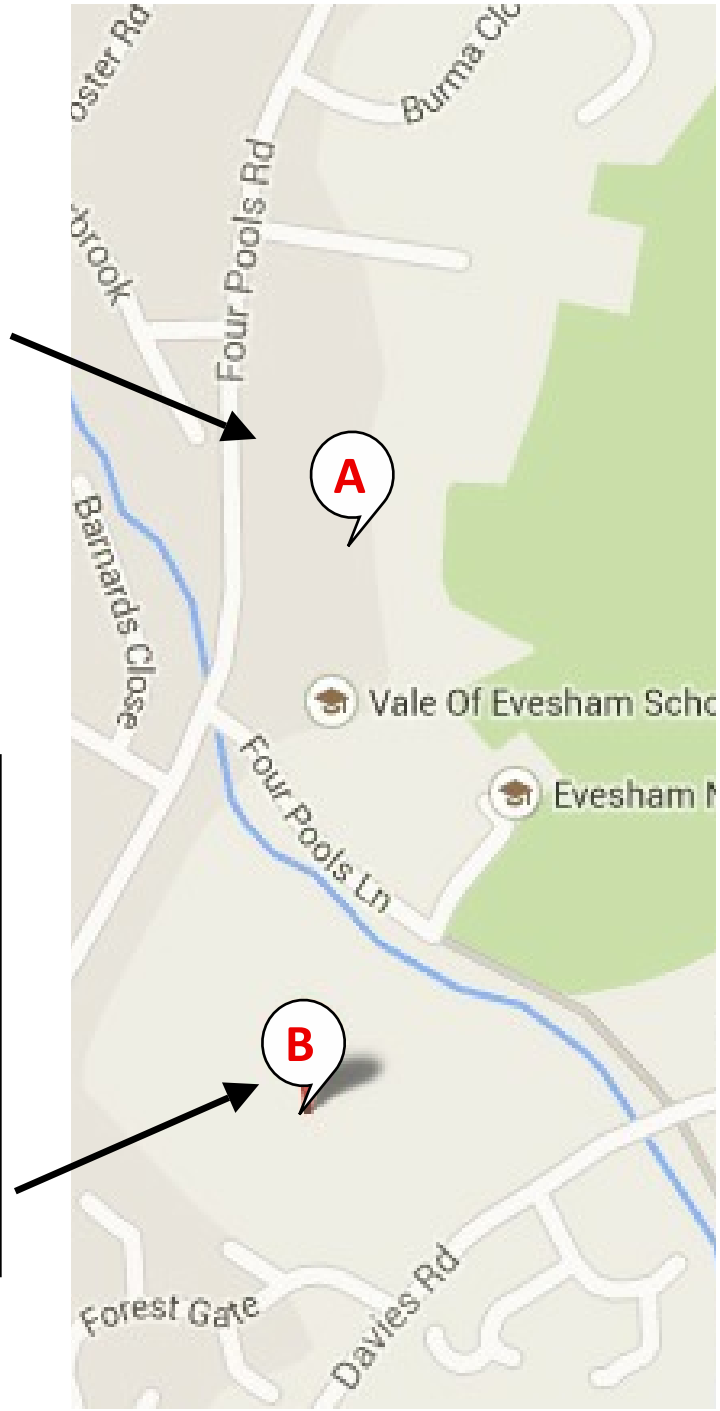

Contest control
All Section Band Secs only
to report here.

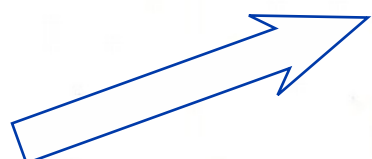
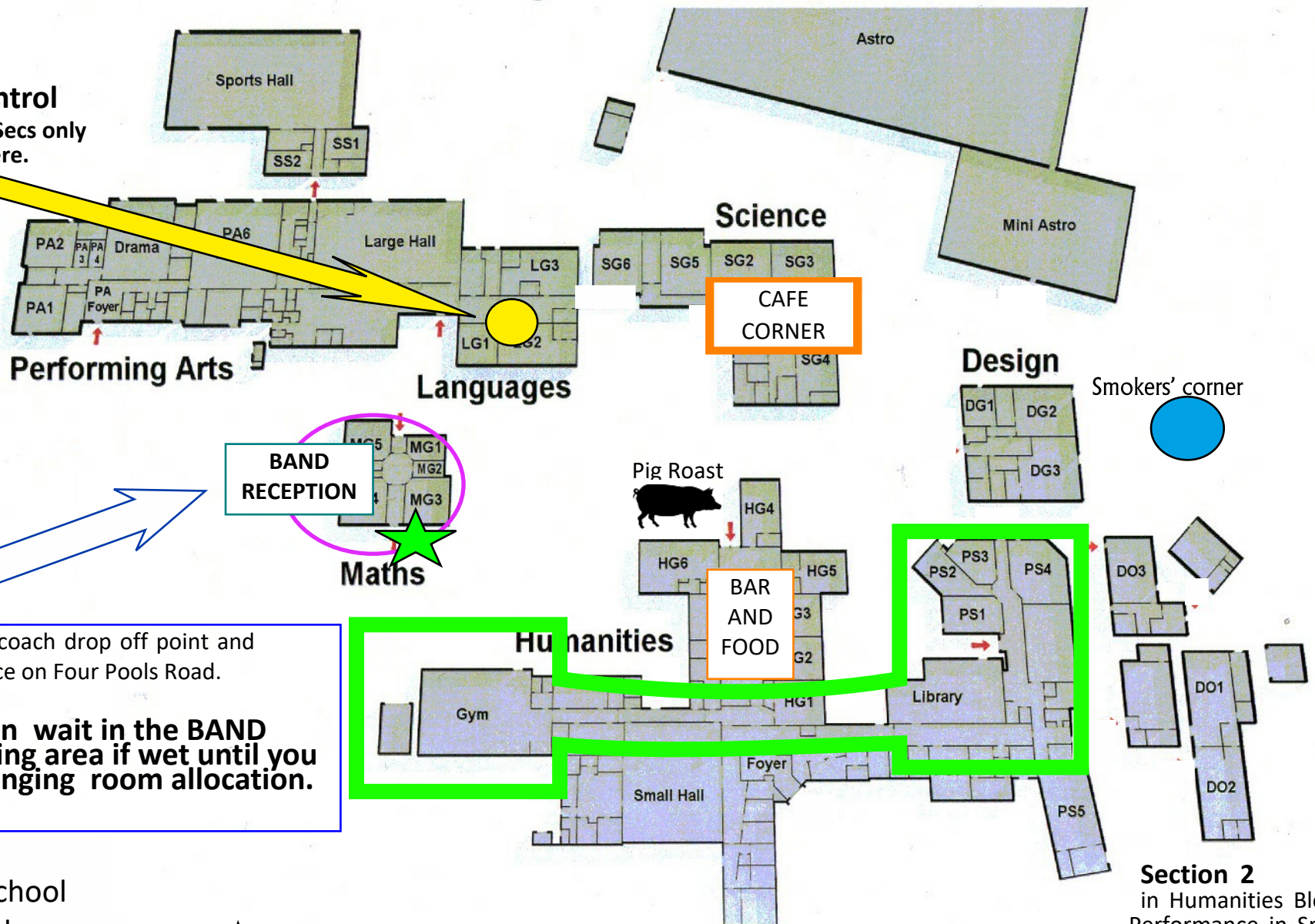
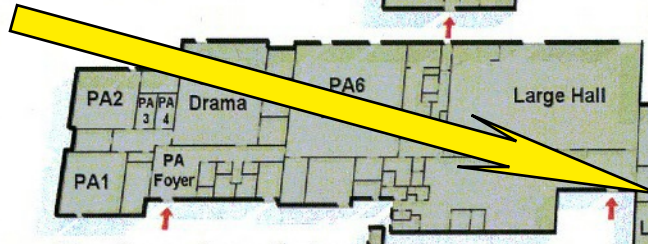

BAND RECEPTION

Maths

CAFE CORNER

BAR AND FOOD

Smokers' corner

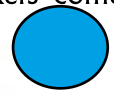

Entry from the coach drop off point and main entrance on Four Pools Road.

Your band can wait in the BAND RECEPTION waiting area if wet until you receive your changing room allocation.

De Montfort School
Four Pools Road,
Evesham,
Worcestershire
WR11 1DQ

 = Information Point

General Layout Plan : SECOND SECTION

(see following pages for details)

De Montfort School (Main Building)

Section 2
in Humanities Block
Performance in Small Gym

BAND ARRIVAL: please go to Band Reception Area from main entrance to wait there.

BAND SECS: then please go to **CONTEST CONTROL** to collect your wrist bands and get your waiting room allocation.

THEN: Please go to your appointed **WAITING AREA** in the **HUMANITIES BLOCK** (go round the outside of the bar— there is no access via the public entrance) no sooner than **ONE HOUR** before you go on stage.

Use the **RED** route to registration and on to the **SMALL GYM** to compete. Return the same way. Please vacate your changing room after performing asap.

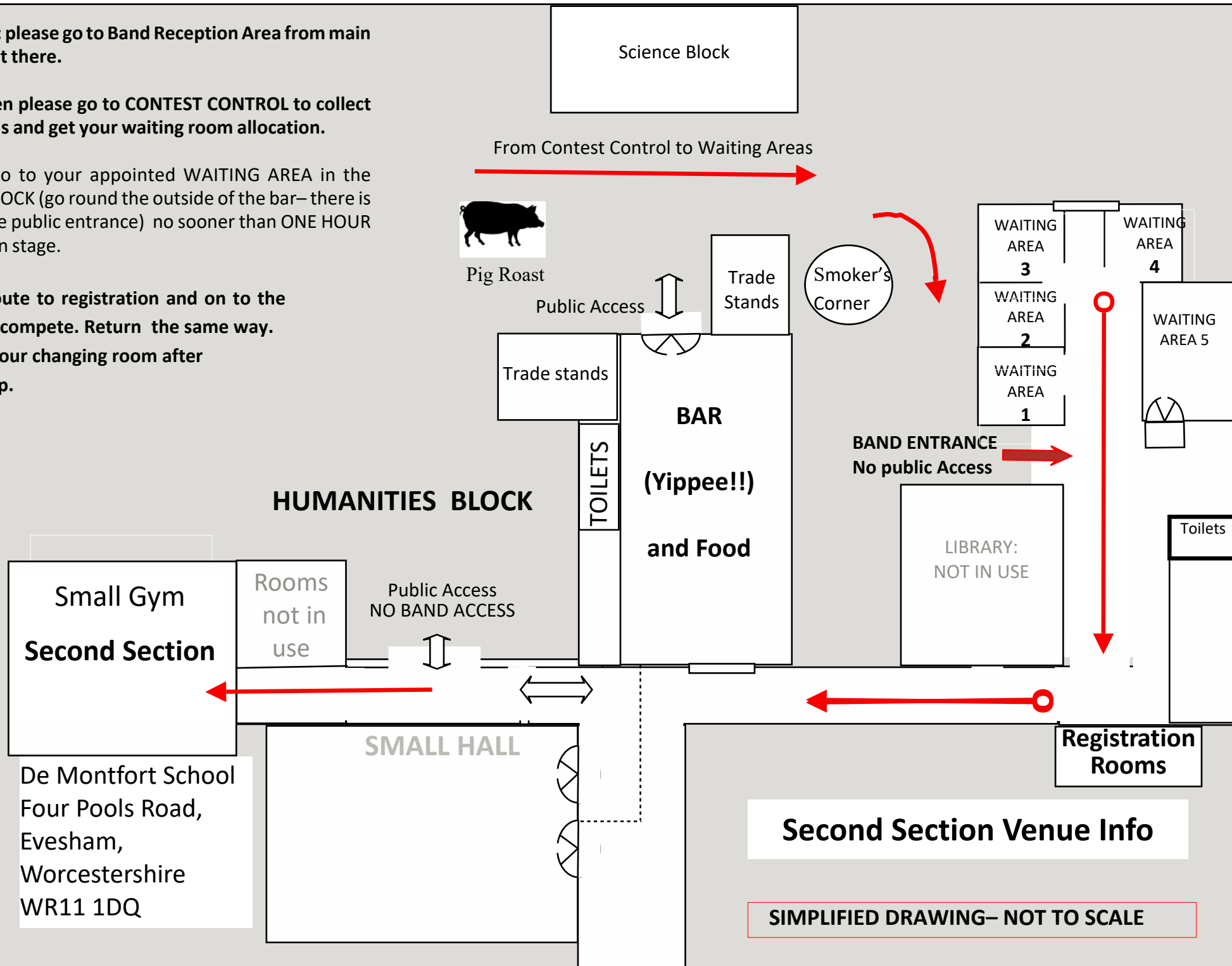

SIMPLIFIED DRAWING— NOT TO SCALE

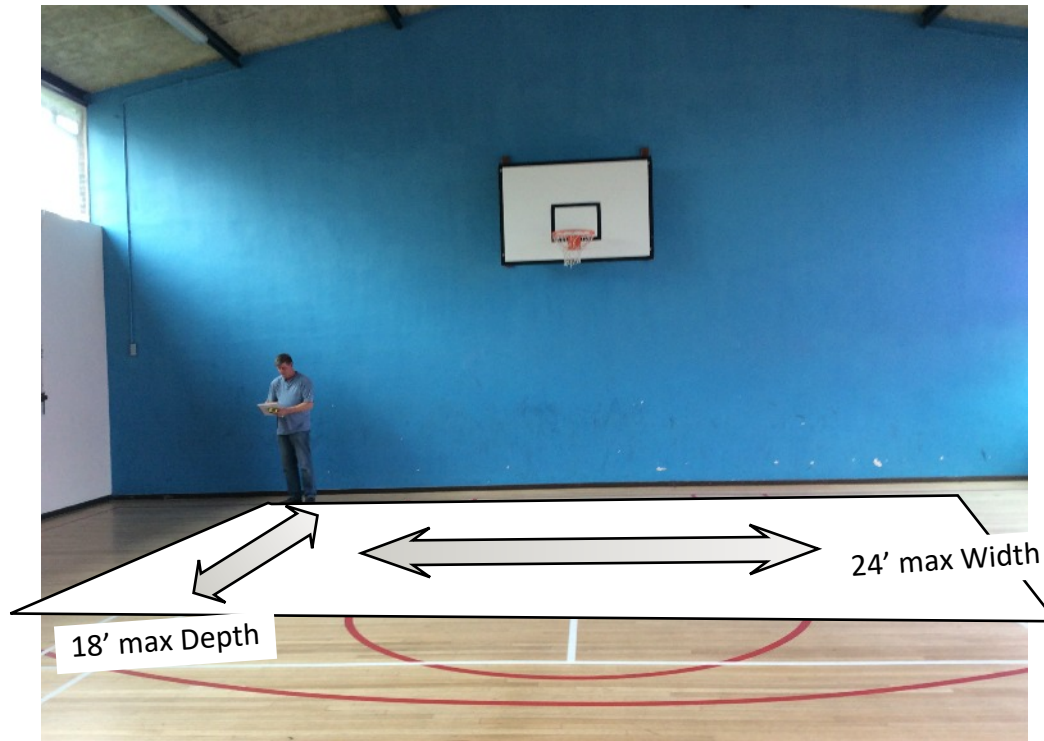

The **Small Gym** is reasonable size.

Its total length is approximately 60 feet long and it is about 30 feet wide in total which allows for a performance area of 18 by 25 feet.— or possibly slightly more.

Audio visual is possible in this hall and a portable screen will be to hand.

IF YOU INTEND PROVIDING AUDIO VISUALS TO ACCOMPANY YOUR PERFORMANCE PLEASE CONTACT :

Steve Price for details of correct file format for use with our equipment.

Steve Price: sprice@prg.com or 07711591937

The hall will be carpeted throughout and sound insulating screens/curtains erected down the sides and back to help the acoustics. This is an untried venue but it is likely to be quite boomy.

**WFB WILL PROVIDE THE FOLLOWING PERCUSSION
IN EACH HALL:**

4 x Timpani & stool (32"/30"/28"/25")

1 x Xylophone

1 x Tubular Bells

1 x Concert Bass Drum

1 x Tam Tam

1 x Drum Kit

1 x Glock

1 x Vibraphone

1 x percussion technician

PLEASE NOTE:

Any further percussion instruments required other than that provided by the Festival Management, must be provided by the band, and will need to be agreed with the WFB Contest Secretary by 14th October, 2017.

Contest Secretary:

Kevin Whittaker: 07970816696

kevinwhittaker@blueyonder.co.uk

Percussion Layout: The Timps and the Kit are in fixed positions as shown.

Anything else can be moved– but please consult with the technician.

**And please try to ensure that all percussion is returned to the original positions
BEFORE leaving the stage! Thank you!**

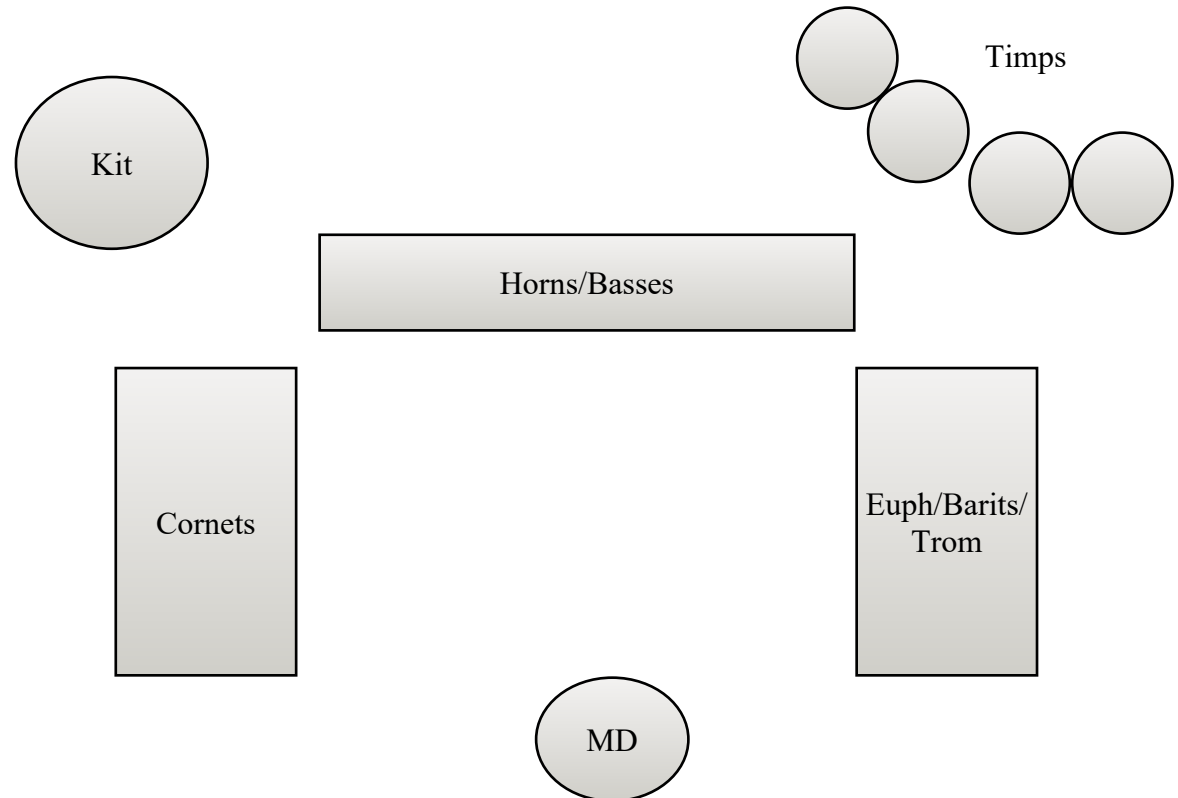

Catering arrangements for 2017

The Fleece Inn will be providing reasonably priced catering services throughout the day, starting at about 9.00am:

As in previous years, **a full bar will be in operation** serving alcoholic drinks and beverages.

Breakfast baps, snacks and delicatessen foods should be available throughout the day in the bar area.

Cafe Corner, will be open too, offering teas, coffee and sandwiches and cakes. Please see the map for its position. It will be easily accessed from the Main Hall area and the bar.

Opening times are still under discussion.

If you've not tried the now famous **Pig Roast** – do give it a try! Shown as a



Pig Roast

All our catering is close together allowing for easy movement between the different facilities.

The bar will close at 10.30pm.

A full food tariff will be available on the day. In addition, Evesham has many food and bar outlets should you wish to go off site.